

Plat of Survey

of

The West 40 feet of Lot 14 of Oak Park of Turtle Lake,  
a subdivision located in Government Lot 1 in the Southeast 1/4 of Section 11, Town  
3 North, Range 15 East, Town of Richmond, Walworth County, Wisconsin.

Surveyed for: **Lloyd & Carol Behrens**  
N6327 Highway 89  
Delavan, Wisconsin. 53115



East 1/4 Corner  
Section 11-3-15  
N. 270.255.30  
E. 2,354,403.65

Bearings referenced to the East line of the Southeast 1/4 of Section 11-3-15,  
recorded as N1°59'38"W in the Wisconsin State Plane Coordinate System,  
South Zone, (NAD-27).

Coordinates are referenced to the Wisconsin State  
Plane Coordinate System, South Zone, (NAD-27).

recorded as N1°59'38"W 1619.46' State Plane  
N. 270.255.30  
E. 2,354,403.65

East line of the Southeast 1/4 of Section 11-3-15

Witness Corner  
Section 11-3-15  
N. 268,636.90  
E. 2,354,459.99

(S76°35'W 600')  
S74°35'25"W 600.31'

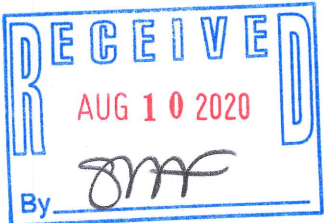

Copyright© 2020 by Olson Land Surveying, LLC.

All rights reserved. No part of this survey plat may be reproduced or transmitted in any form by any means - graphic, electronic, or mechanical, including photocopying, tracing, or information storage and retrieval systems - without permission in writing from Douglas G. Olson, Olson Land Surveying, LLC.

I hereby certify that I have surveyed the above described property in compliance with Chapter A-E 7 of the Wisconsin Administrative Code and that the map hereon is correct to the best of my professional knowledge and belief and shows the size and location of the property, its exterior boundaries, the location and dimensions of all visible structures thereon, boundary fences, apparent easements and roadways and visible encroachments, if any.

This survey is made for the exclusive use of the present owners of the property, and also those who purchase, mortgage or guarantee title thereto, within one year from the date hereof.

Douglas G. Olson  
Wisconsin Professional Land Surveyor - 2093

Turtle

Lake

Water Elevation  
05-21-2020=900.13

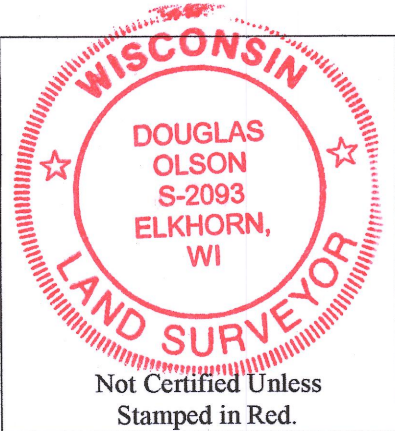

Notes:

- 1) This Plat of Survey is not certified unless signed and sealed in red ink.
- 2) This survey is subject to Wisconsin lien laws. This Plat of Survey is the notice of intent to file lien. Lien waiver required.
- 3) The Survey Date shown on this Plat of Survey is the completion date of the field work.

2020.044

Sheet 1 of 1 Sheets

Drawing Name:

Job Reference Number  
2020.044

Legend of Symbols & Abbreviations

- Found County Section Corner
- Found Iron Pipe
- Recorded Information
- Utility Pole
- Utility Pedestal
- Concrete Cover
- Septic Vent
- Asphalt Surface
- Concrete Surface

- N North
- S South
- E East
- W West
- In Bearings
- Degrees
- Minutes
- Seconds
- In Distances
- Feet
- Inches

**OLSON**  
LAND SURVEYING, LLC  
Rural | Residential | Commercial

45 South Wisconsin Street | P.O. Box 322  
Elkhorn, Wisconsin. 53121  
Telephone: (262) 723-3434  
Facsimile: (262) 723-8044  
Email: doug@olsonsurveying.com  
Website: www.olsonsurveying.com

Scale in Feet  
1" = 20'



Survey Date: May 21, 2020.

Revisions:

COP-11

315-1384